

The image features two pairs of glasses against a light, textured background. On the left is a pair of teal-colored glasses with a modern, slightly curved frame. On the right is a pair of grey-colored glasses with a similar frame style. Both pairs have clear lenses and white nose pads. The text 'Tom's Design' is positioned in the upper right, with 'DESIGNED BY INSTINCT' below it. At the bottom center, the word 'VYCOZ' is written in large, white, sans-serif capital letters.

Tom's Design™
DESIGNED BY INSTINCT

VYCOZ

NEW DESIGNER BRAND IN TOWN!

„VYCOZ“, das heißt „aus Korea“. Daher, nämlich aus Seoul, kommt dieses neue, junge Label. Hier finden Design und Produktion statt. Ein eigenes Produktions-Knowhow verleiht der Brand Authentizität, eine starke Identität und natürlich Unabhängigkeit und Flexibilität.

Die Brand überzeugt mit einer zeitgenössischen, retro-modernen Designsprache. Hier treffen Tradition und Qualität auf moderne Designs – clean, pur, reduziert.

Der professionelle Kollektionsaufbau in sieben Teilkollektionen greift dabei auf unterschiedlichste Materialien zurück. Im Sortiment finden sich neben Biokunststoffen z. B. auch Sheet Metal Frames. Viele Modelle verfügen über schraubenlose Scharniere und zu manchen Modellen gibt es sogar hochwertig gefertigte Sun Clip-Ons.

Zusätzlich bietet VYCOZ eine starke Young Fashion-Kollektion, die sehr erwachsen wirkt – die clever konzipierte Style-DNA mit klarer Designsprache macht auch hier den Unterschied.

Entdecken Sie mit uns die innovativen und ästhetischen Modelle der Marke „VYCOZ“.

CONTACT / ORDER > 3

PRODUCT CATALOGS > 4

PRODUCT MANUALS > 10

VIDEO – HOW TO USE VYCOZ TOOLS > 13



CONTACT

Tom's Design GmbH
Hauptstr. 36
58540 Meinerzhagen
Fon: +49 2354 942 92 35
E-Mail: info@toms-design.de
www.toms-design.de

ORDER

Bitte bestellen Sie per Mail an
› info@toms-design.de

Ansprechpartnerin: Frau Zielinski
Bürozeiten: Mo, Mi, Fr, 09:00 – 12:00



ECO WIRE



BARO 49□20 148
SMOG / MUD / TEAL / OLIVE



CARO 50□18 148
BLK / BRN / GRY / CRT



DORO 49□22 148
BLK / GRY / NAV / CRT



GARO 50□19 148
DGRY / LBRN / LPINK / LTOP



HERO 48□22 148
BLK / BLK-GD / BRN / GRY /
NAV / MPUR / RED / TOP



JARO 50□19 148
SMOG / MUD / OLIVE / MTOP



JURO 51□20 148
DGRY / DNAV / LBRN / LGRY



MIRO 53□17 148
BLK / BLK-GD / BRN / GRY /
NAV / MPUR / TOP / CRT



RORO 46□22 148
BLK / GRY / RED / CRT



SARO 50□19 148
BLK / GRY / RED / CRT



SERO 49□22 148
DGRY / LGRY / LPINK / LTOP



TARO 55□16 148
SMOG / MUD / TEAL / STONE



MAX WIRE



BAON 50□21 145
BLK / BK-GUN / BR-GOL /
MGOL



GAON 45□22 145
BLK / BK-GUN / BR-GOL /
WINE



JAON 49□19 145
BLK / BK-GUN / BR-GOL /
MGOL



NAON 49□19 145
BLK / BR-GOL / WINE / ROSE



REON 52□17 145
BLK / BK-GUN / BR-GOL /
MSIL



SION 51□20 145
BLK / BRN / BR-ORG /
BR-GOL



TEON 53□19 145
BLK / BRN / MSIL

MAX CLASSIC



BORA 47□22 148
SBLK / WOOD / SAGE /
LEMON



CARA 51□20 148
SBLK / WOOD / MIDNIGHT /
SAGE



JARA 54□16 148
SBLK / WOOD / MIDNIGHT /
SAGE



MARA 53□19 148
SBLK / WOOD / MIDNIGHT /
SAGE



RORA 48□22 148
SBLK / WOOD / MIDNIGHT /
LEMON



SORA 48□21 148
SBLK / WOOD / MIDNIGHT /
LEMON

MAX FLEX



BENY 49□18 145
BLK / GUN / BLU / MSIL



CONY 46□19 145
BLK / PINK / BLU / AQA



HANY 47□18 145
BLK / GUN / AQA / GOL



JUNY 48□18 145
BLK / BRN / BLU / MSIL



PANY 48□18 145
BLK / BRN / ROSE



RANY 49□19 145
BLK / ROSE / GOL

INCLINE T



BETA 52□20 144
SBLK / BRN / GRY / CRT



CETA 49□21 144
SBLK / BRN / GRY / CRT



JETA 50□21 144
SBLK / BRN / GRY / SMOG /
MUD / TEAL / OLIVE / CRT-NAV



LATA 46□23 144
SBLK / BRN / GRY / NAV



LITA 44□23 144
SBLK / BRN / GRY / RED



META 52□20 144
SBLK / BRN / GRY / NAV



TATA 49□20 144
SBLK / BRN / GRY / NAV



JOTA 52□21 144
SBLK / BRN / GRY / NAV /
SMOG / MUD / TEAL / OLIVE



KOTA 48□23 144
SBLK / BRN / GRY / SMOG /
MUD / OLIVE / CRT-NAV



MATA 56□18 144
SBLK / BRN / GRY / NAV /
SMOG / MUD / TEAL / OLIVE



Polarized
CLIP-ON
GREY / BRN / GRN



Polarized
CLIP-ON
GREY / BRN / GRN



Polarized
CLIP-ON
GREY / BRN / GRN



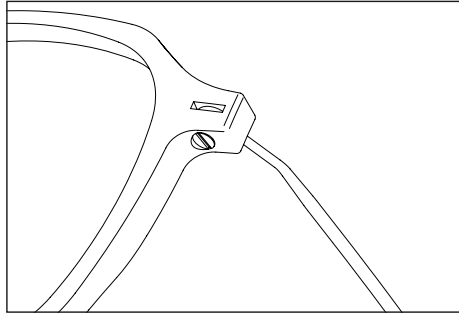

STREAM HINGE

SINCE 2019

Designed with VYCOZ's exclusive technology, Stream Hinge presents a soothing silhouette, just like flow of a water stream. The pin, invented by VYCOZ expertise, securely holds numerous folding test and has created a perfected embodiment.

TOOL

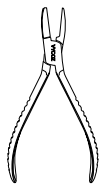

ASSEMBLE PLIERS



FLAT-HEAD-DRIVER



PICKER-AWL

FITTING

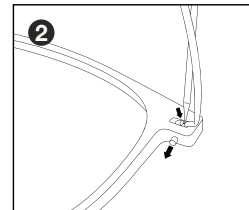
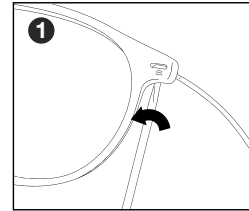

HINGE REMOVAL

FLAT-HEAD-DRIVER PICKER-AWL

① Using the Flathead screwdriver and gently turn it 5 to 7 times without excessive force.

A pin head should come out about halfway in the outward.

② Disconnect a temple pushing a pin outward using the Picker-Awl.

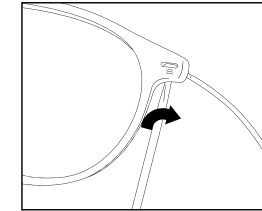

HINGE ASSEMBLY

Flat-Head Driver ASSEMBLE PLIERS

① Assemble a pin completely by slight force while turning the Flathead driver clockwise until a pin is fully seated.



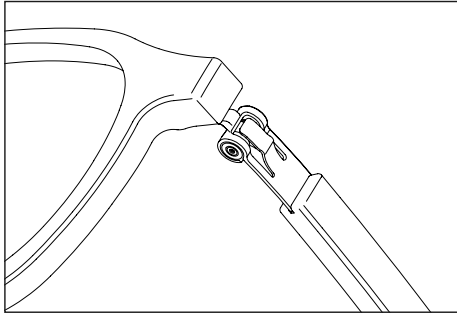

SPHERE HINGE

SINCE 2014

Sphere Hinge focuses on the ideal balance which maximizes comfort and durability.

The flexible solidity comes from stainless steel construction allows seamless integration with various front materials, while showcasing a timeless aesthetic.

TOOL

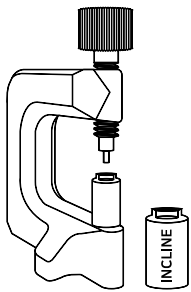

PIN REMOVAL

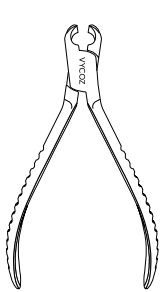

REMOVAL PLIERS

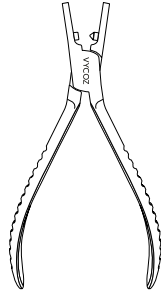

MAX PLIERS

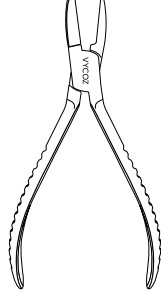

ASSEMBLE PLIERS



STICK 2.7Ø

FITTING

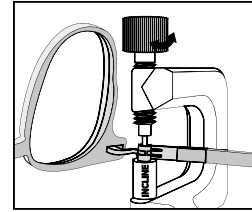

HINGE REMOVAL

PIN REMOVAL

① After connect the Hinge on the Jig of the Pin Removal, tighten it til "Click" sound. Then the hinge is disconnected.

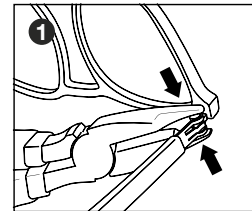

HINGE ASSEMBLY

ASSEMBLE PLIERS MAX PLIERS

① Fix a pin a ring, and tighten them with Assemble Pliers.

And then, tighten them once again.

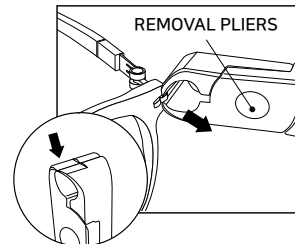
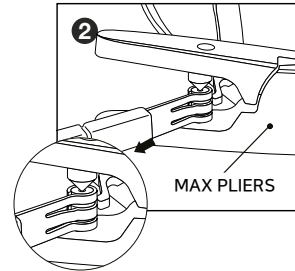

DOT REMOVAL

REMOVAL PLIERS

① Grab the F-Pin with Removal Pliers and pull it out at once.

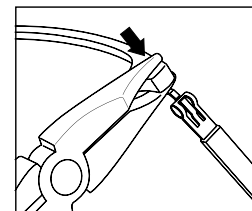

DOT ASSEMBLY

ASSEMBLE PLIERS

① Station the 'F'-Pin in the place, and assemble with Assemble Pliers.

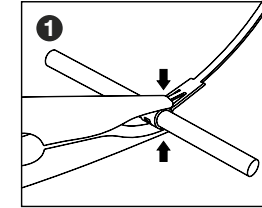

TEMPLE REPAIR

ASSEMBLE PLIERS STICK 2.7Ø

① Insert a 2.7Ø pin into the 'bending part' then tighten it by turning with pliers.

② Hold the 'bending part' on the temple and slightly bend it backward.

③ Place it on the measurement image (image 3) and adjust the angle.

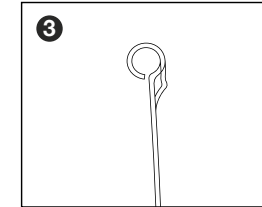
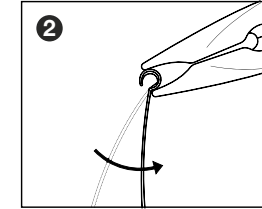

CAUTION

There is a risk of breakage or deformation if excessive force is applied.

Check if the product and the photo no. 3 are matched.

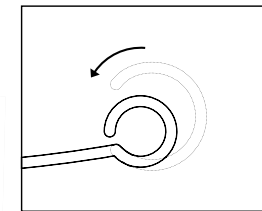

Tighten the round shape part and see whether the pin head goes in.

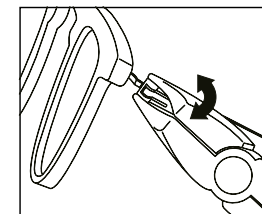

ANGLE ADJUSTMENT

ASSEMBLE PLIERS

① Grab the top and bottom of the Hinge with the Assemble Plier, and adjust the angle.



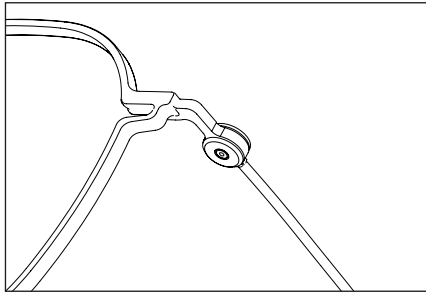

PIVOT HINGE

SINCE 2020

Pivot Hinge is composed of four precisely machined components and prevents distortion and worn-out.

Moreover, its lightweight design contributes to maintaining the total weight of Max series at around 6-8g.

TOOL

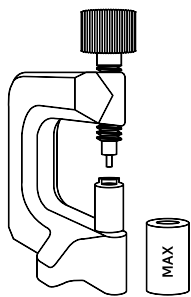

PIN REMOVAL

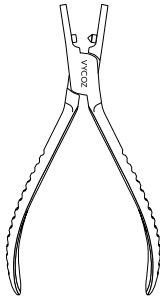

MAX PLIERS

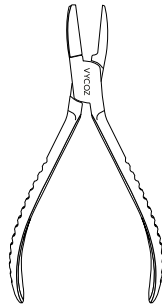

ASSEMBLE PLIERS

FITTING

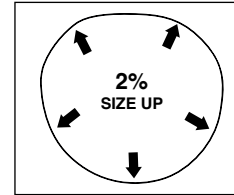

LENS CUTTING

① Recommend to use demo lens as a pattern. Enlarge the size for 2% in the cutting machine.

Index
 - CR39 1.60 or higher
 - Polycarbonate lens
 - Nylon lens

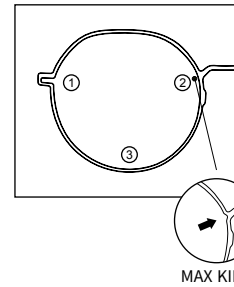

LENS ASSEMBLY

① Insert a lens by hand or using fishing wire in numerical order.

* A little bump in the rim prevents rotating lens. (MAX KIDS)

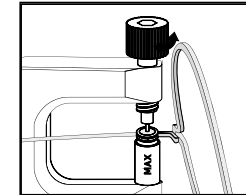

HINGE REMOVAL

PIN REMOVAL

① Place the hinge onto the Pin Remover jig, and rotate the crown located on the top to detach a pin from the ring.

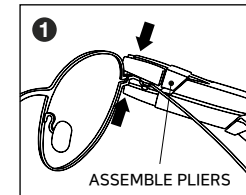

HINGE ASSEMBLY

ASSEMBLE-PLIERS MAX-PLIERS

① Assemble and tighten a ring and pin initially, then use pliers to securely tighten a ring to prevent loosening.

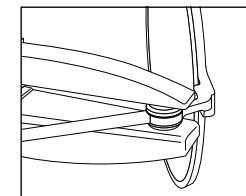
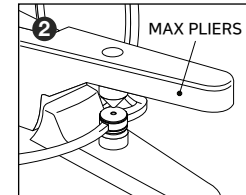

FITTING INCLINE

ASSEMBLE PLIERS

① Use pliers to grip the white wire vertically and make fine adjustments to the angle.



